



TK International  
020 7794 8700  
www.t-k.co.uk

Residential Sales  
Residential Lettings  
Property Management

Sales Office:  
9 Heath Street  
Hampstead  
London NW3 6TP  
E: sales@t-k.co.uk

Lettings Office:  
16-18 Heath Street  
Hampstead  
London NW3 6TE  
E: lettings@t-k.co.uk

tk.international  
TK International  
TK International

Est.  
1998



## **Bunkers Hill** **Hampstead Garden Suburb** **NW11**

A delightful and rarely available Grade II Listed, 4-5 bedroom family house, situated on a private close of only two houses, off Wildwood Road between the Heath Extension and Hampstead Golf Course.

Occupying an elevated position and boasting wonderful views of the Heath, the accommodation enjoys a 31' triple aspect reception room and a double aspect kitchen/breakfast room on the ground floor, both with direct access to the garden.

The first floor offers the principle bedroom with dressing room/bedroom 5 & en-suite bathroom as well as two further bedrooms and a family bathroom. The second floor provides a large double bedroom with shower room.

This wonderful home is surrounded by gardens to three sides, boasts a detached garage plus parking for two further cars and is located within 1.5 miles of Hampstead Village.

**£2,495,000**

**SOLE AGENT**

**Freehold**























# Bunkers Hill NW/1

Gross internal area (approx.)

227 Sq m (2439 Sq ft) Including under eaves and under 1.5m

201 Sq m (2165 Sq ft) Excluding under eaves and under 1.5m

23 Sq m (246 Sq ft) Estimated Garage

For identification only, Not to Scale

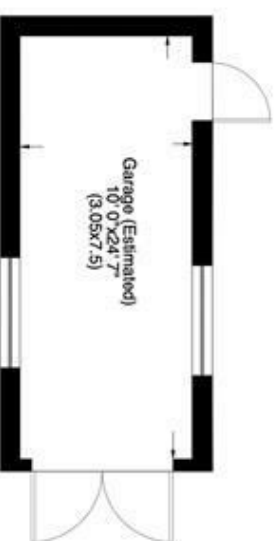

Ground Floor



www.WilliamsSalisbury Photography

Not to Scale, for guidance only and must not be relied upon as a statement to fact. All measurements are approximate only (and have been prepared in accordance with the current edition of the RICS Code of Measuring Practice).

# Bunkers Hill NW11

Acre 0.24 (approx.) Not including drive  
For identification only, Not to Scale

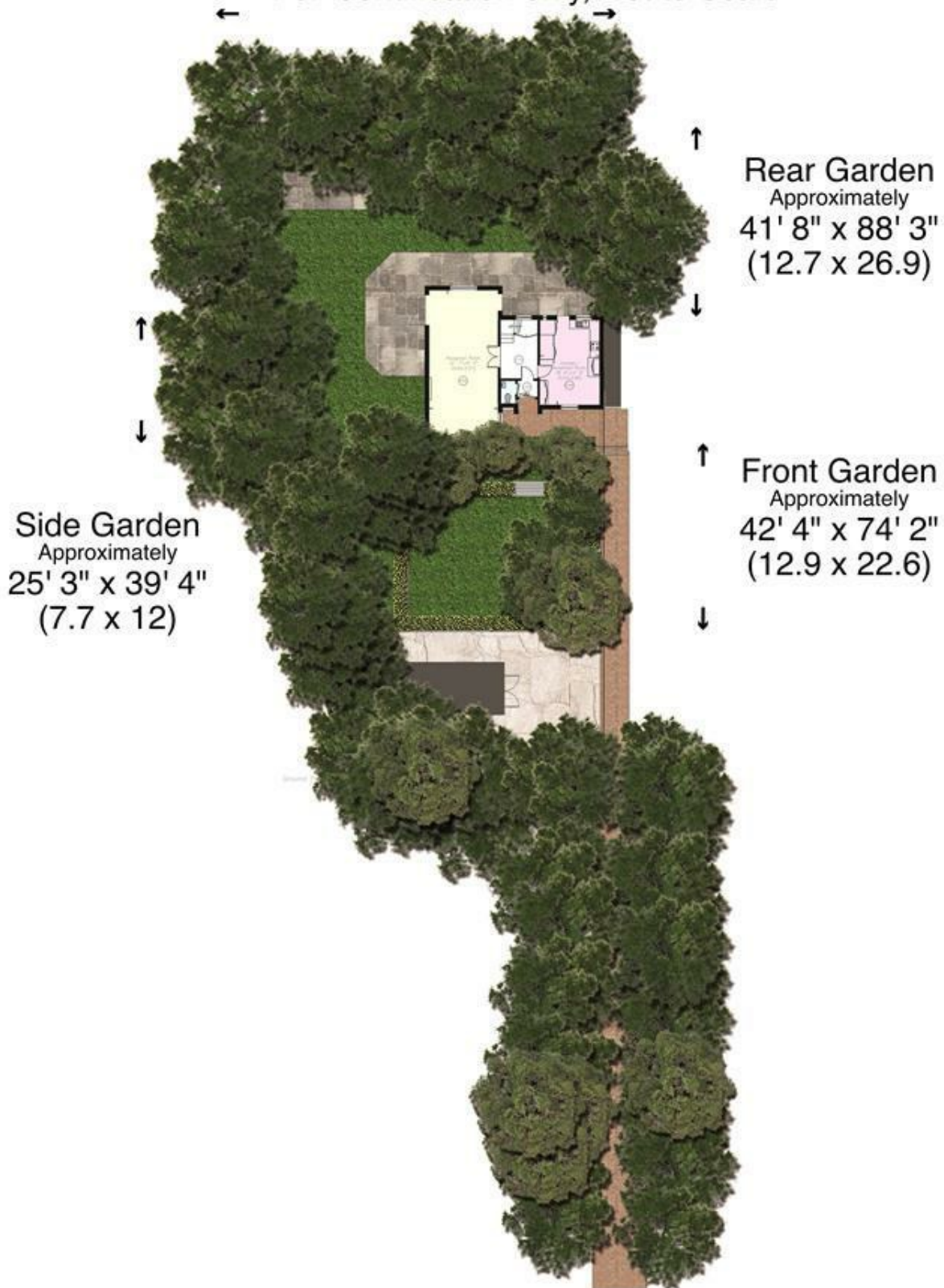

[www.WilliamSalisbury.Photography](http://www.WilliamSalisbury.Photography)

Not to Scale, for guidance only and must not be relied upon as a statement to fact. All measurements areas are approximate only (and have been prepared in accordance with the current edition of the RICS Code of Measuring Practice).